

Hub Installations and Replacements for Front Hubs	2
Hub Installations and Replacements for Rear Hubs	4
Hub Installations and Replacement Parts for Cush Drive Rear Hubs	6
Hub Installations and Replacement Parts for Front Hubs with Dual Brake Disc.....	7
Torque Settings KTM EXC / Husqvarna TE-FE / GasGas EC	8
Honda CRF – General Torque Settings	9
Yamaha WR – General Torque Settings	10
Spoke Tension Check.....	11

Hub Installations and Replacements for Front Hubs

HUB FITMENTS AND REPLACEMENTS

HUB FITMENTS AND REPLACEMENTS



FRONT HUBS

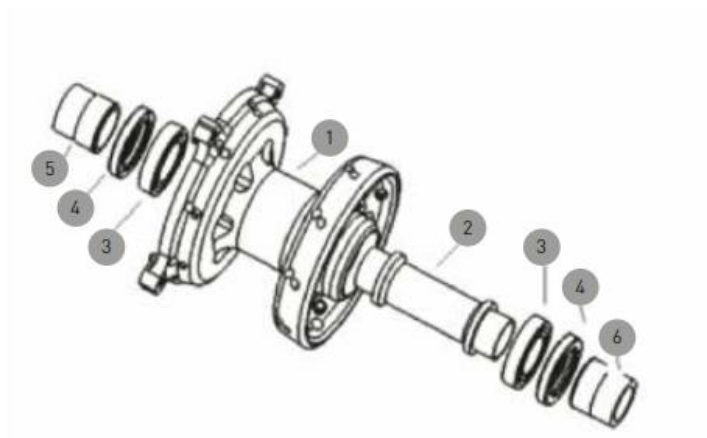

Model	1.Hub Fitment	2.Tube	3.Bearing	4.Seal	5.Disc Spacer	6.Plain Spacer
CR 80/85	SP101	SP101-T	6904	25*37*7	SP101-1	SP102-2
CRF 150	SP181	SP181-T	6904	25*37*7	SP181-1	SP181-2
CR 125/250, CRF 250R/450R	SP153	SP153-T	6905	30*42*7	SP153-1	SP153-2
CRF 250L	SP155	SP155-T	6905	30*42*7	SP155-1	SP155-2
CRF 250X/450X	SP172	SP172-T	6905	30*42*7	SP153-1	SPEEDO DRIVE



Model	1.Hub Fitment	2.Tube	3.Bearing	4.Seal	5.Disc Spacer	6.Plain Spacer
KX 65	SP130	SP130-T	6202	25*35*7	SP130-1	SP130-2
KX 80/85	SP143	SP143-T	6203	25*40*7	SP143-1	SP143-2
KX 125/250 KXF 250/450	SP176	SP176-T	6905	30*42*7	SP176-1	SP176-1



Model	1.Hub Fitment	2.Tube	3.Bearing	4.Seal	5.Disc Spacer	6.Plain Spacer
SX 50	SP300	SP300-T	6203	25*40*7	SP300-2	SP300-3
SX 65 2012-17	SP302	SP302-T	6003	25*35*7	SP302-3	SP302-4
SX 65 2006-11	SP150	SP150-T	6003	25*35*7	SP150-1	SP150-2
SX 85 2012-17	SP301	SP301-T	6905	30*42*7	SP301-1	SP301-1
SX 85 2008-11	SP162	SP162-T	6905	30*42*7	SP162-1	SP162-2
SX/SXF/EXC/EXCF 125-500 26mm Axle	SP157	SP157-T	6906	35*47*7	SP157-1	SP157-1
SX/SXF/EXC/EXCF 125-500 22mm Axle	SP157	SP157-T	6906	35*47*7	SP157-22-1	SP157-22-2
Freeride	SP301	SP301-T	6905	30*42*7	SP301-1	SP301-1

HUB FITMENTS AND REPLACEMENTS



Model	1.Hub Fitment	2.Tube	3.Bearing	4.Seal	5.Disc Spacer	6.Plain Spacer
YZ 85	SP108	SP108-T	6202	25*35*7	SP108-1	SP108-2
YZ 125/250 YZF 250/450	SP185	SP185-T	6905	30*42*7	SP185-4	SP185-5
WRF 240/400/450	SP154	SP154-T	6905	30*42*7	SP154-1	SPEEDO DRIVE
WR 250R	SP186	SP186-T	6203	25*40*7	SP186-1	SP186-2
WR 250X	SP187	SP187-T	6203	25*40*7	SP187-1	SP187-2



Model	1.Hub Fitment	2.Tube	3.Bearing	4.Seal	5.Disc Spacer	6.Plain Spacer
RM 85	SP108	SP108-T	6202	25*35*7	SP108-1	SP108-2
RM 125/250	SP192	SP192-T	6905	30*42*7	SP192-1	SP192-2
RMZ 250/450	SP175	SP175-T	6905	30*42*7	SP175-1	SP175-1
DRZ 400E	SP145	SP145-T	6905	30*42*7	SP145-1	SP145-2



Model	1.Hub Fitment	2.Tube	3.Bearing	4.Seal	5.Disc Spacer	6.Plain Spacer
TC 50	SP300	SP300-T	6203	25*40*7	SP300-2	SP300-3
TC 65	SP302	SP302-T	6003	25*35*7	SP302-3	SP302-4
TC 85	SP301	SP301-T	6905	30*42*7	SP301-2	SP301-3
TC/FC/TE/FE All Models 125-450	SP157	SP157-T	6906	35*47*7	SP157-22-1	SP157-22-2



Model	1.Hub Fitment	2.Tube	3.Bearing	4.Seal	5.Disc Spacer	6.Plain Spacer
TE/FE All Models 250-501	SP157	SP157-T	6906	35*47*7	SP157-22-1	SP157-22-2



Model	1.Hub Fitment	2.Tube	3.Bearing	4.Seal	5.Disc Spacer	6.Plain Spacer
SER/SEF 4T & 2T Enduro Models	SP190	SP190-T	6004	25*42*7	SP190-1	SP190-1



Model	1.Hub Fitment	2.Tube	3.Bearing	4.Seal	5.Disc Spacer	6.Plain Spacer
EC Enduro Models	SP167	SP167-T	6905	30*42*7	SP167-1	SP167-1



Model	1.Hub Fitment	2.Tube	3.Bearing	4.Seal	5.Disc Spacer	6.Plain Spacer
RR 4T & 2T Enduro Models	SP191	SP191-T	6906	35*47*7	SP191-1	SP191-1

WHEELS

RIMS

HUBS

BRAKES

Hub Installations and Replacements for Rear Hubs

HUB FITMENTS AND REPLACEMENTS



REAR HUBS

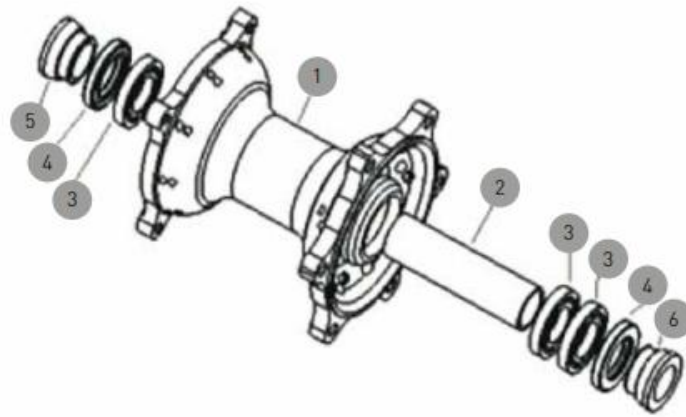

Model	1.Hub Fitment	2.Tube	3.Bearing	4.Seal	5.Disc Spacer	6.Plain Spacer
CR 80/85	SP103	SP103-T	6202	25*35*7	SP103-1	SP103-1
CRF 150	SP068	SP068-T	6003	25*35*7	SP068-1	SP068-2
CR 125/250 2002-2007	SP047	SP047-T	6005	30*47*7	SP047-1	SP047-1
CRF 250 2004-13, CRF 450 2002-12	SP047	SP047-T	6005	30*47*7	SP047-1	SP047-1
CRF 250 2014-17, CRF 450 2013-17	SP012	SP012-T	6005	30*47*7	SP012-1	SP012-2
CRF 250L	SP045	SP045-T	6203	25*40*7	SP045-1	SP045-2
CRF 250X/450X	SP047	SP047-T	6005	30*47*7	SP047-1	SP047-1

Kawasaki

Model	1.Hub Fitment	2.Tube	3.Bearing	4.Seal	5.Disc Spacer	6.Plain Spacer
KX 65	SP027	SP027-T	6202	25*35*7	SP027-1	SP027-2
KX 80/85	SP042	SP042-T	6004	30*42*7	SP042-1	SP042-1
KX 125/250 KXF 250/450	SP053	SP053-T	6005	30*47*7	SP053-1	SP053-1



Model	1.Hub Fitment	2.Tube	3.Bearing	4.Seal	5.Disc Spacer	6.Plain Spacer
SX 50 2004-13	SP066	SP066-T	6203	25*40*7	SP066-1	SP066-2
SX 50 2014-17	SP067	SP067-T	6003	25*35*7	SP067-1	SP067-2
SX 65	SP049	SP049-T	6003	25*35*7	SP049-3	SP049-4
SX 85	SP057	SP057-T	6005	30*47*7	SP057-1	SP057-1
SX/SXF/EXC/EXCF 125-500 20mm Axle	SP052	SP052-T	6005	30*47*7	SP052-1-12	SP052-2-12
SX/SXF/EXC/EXCF 125-500 25mm Axle	SP052	SP052-T	6005	30*47*7	SP052-13	SP052-13
Freeride	SP057	SP057-T	6005	30*47*7	SP057-1	SP057-1



Model	1.Hub Fitment	2.Tube	3.Bearing	4.Seal	5.Disc Spacer	6.Plain Spacer
YZ 85	SP010	SP010-T	6202	25*35*7	SP010-1	SP010-2
YZ 125/250 YZF 250/450	SP074	SP074-T	6005	30*47*7	SP074-1	SP074-2
WRF 250/400/450	SP074	SP074-T	6005	30*47*7	SP074-3	SP074-3
WR 250 R/X	SP082	SP082-T	6005	30*47*7	SP082-1	SP082-2



Model	1.Hub Fitment	2.Tube	3.Bearing	4.Seal	5.Disc Spacer	6.Plain Spacer
RM 85	SP010	SP010-T	6202	25*35*7	SP010-1	SP010-2
RM 125/250	SP092	SP092-T	6005	30*47*7	SP092-1	SP092-2
RMZ 250/450	SP063	SP063-T	6005	30*47*7	SP063-1	SP063-1
DRZ 400E	SP044	SP044-T	6005	30*47*7	SP044-1	SP044-2



Model	1.Hub Fitment	2.Tube	3.Bearing	4.Seal	5.Disc Spacer	6.Plain Spacer
TC 50	SP067	SP067-T	6003	25*35*7	SP067-1	SP067-2
TC 65	SP049	SP049-T	6003	25*35*7	SP049-3	SP049-4
TC 85	SP057	SP057-T	6005	30*47*7	SP057-1	SP057-1
TC/FC/TE/FE All Models 125-450	SP052	SP052-T	6005	30*47*7	SP052-13	SP052-13



Model	1.Hub Fitment	2.Tube	3.Bearing	4.Seal	5.Disc Spacer	6.Plain Spacer
TE/FE All Models 250-501	SP052	SP052-T	6005	30*47*7	SP052-13	SP052-13



Model	1.Hub Fitment	2.Tube	3.Bearing	4.Seal	5.Disc Spacer	6.Plain Spacer
SER/SEF 4T & 2T Enduro Models	SP090	SP090-T	6005	32*47*7	SP090-1	SP090-2



Model	1.Hub Fitment	2.Tube	3.Bearing	4.Seal	5.Disc Spacer	6.Plain Spacer
EC Enduro Models	SP058	SP058-T	605	30*47*7	SP058-1	SP058-2



Model	1.Hub Fitment	2.Tube	3.Bearing	4.Seal	5.Disc Spacer	6.Plain Spacer
RR 4T & 2T Enduro Models	SP091	SP091-T	6005	30*47*7	SP091-1	SP091-2

WHEELS

RIMS

HUBS

S

Hub Installations and Replacement Parts for Cush Drive Rear Hubs

HUB FITMENT AND REPLACEMENT PARTS

CUSH DRIVE REAR HUBS

Model	Hub Fitment	Tube	Bearing	Seal	Sprocket Spacer	Disc Spacer	Carrier Spacer	Carrier	Cush Rubber
BMW F800GS	SP714	SP714-T	6204	30*47*7	SP714-1	SP714-2	SP714-3	SP712-C	SP714-R
CRFL 1000 Africa Twin	SP715	SP715-T	6204	30*47*7	SP715-1	SP715-2	SP715-3	SP715-C	SP715-R
KTM 950/990	SP712	SP712-T	6205	30*52*7	SP712-1	SP712-2	SP712-3 & SP712-4	SP712-C	SP715-R
KTM 690	SP813	SP813-T	6205 & 6006	30*52*7	SP813-1	SP813-2	SP813-3	SP813-C	SP813-R
DR 650	SP060	SP060-T	6205 & 6204	30*52*7	SP060-1	SP060-2	SP060-3	SP060-C	SP060-R
All Honda CRF 2013 on	SP816	SP816-T	6005 & 6205	30*47*7	SP816-1	SP816-2	SP816-2	SP816-C	SP816-R
All KTM before 2013	SP832	SP832-T	6005 & 6006	30*47*7	SP832-1	SP832-2	SP832-3	SP832-C	SP832-R
All KTM 2013 on	SP832	SP832-T	6005 & 6006	30*47*7	SP832-4	SP832-5	SP832-6	SP832-C	SP832-R
Yamaha 125/250 with 22mm spindle	SP874	SP874-T	6005 & 6205	30*47*7	SP874-1	SP874-2	SP874-3	SP874-C	SP874-R
Yamaha 250/450F 2014 on with 25mm spindle	SP874	SP874-T	6005 & 6205	30*47*7	SP874-4	SP874-5	SP874-6	SP874-C	SP874-R

www.smpo.co.uk

Hub Installations and Replacement Parts for Front Hubs with Dual Brake Disc

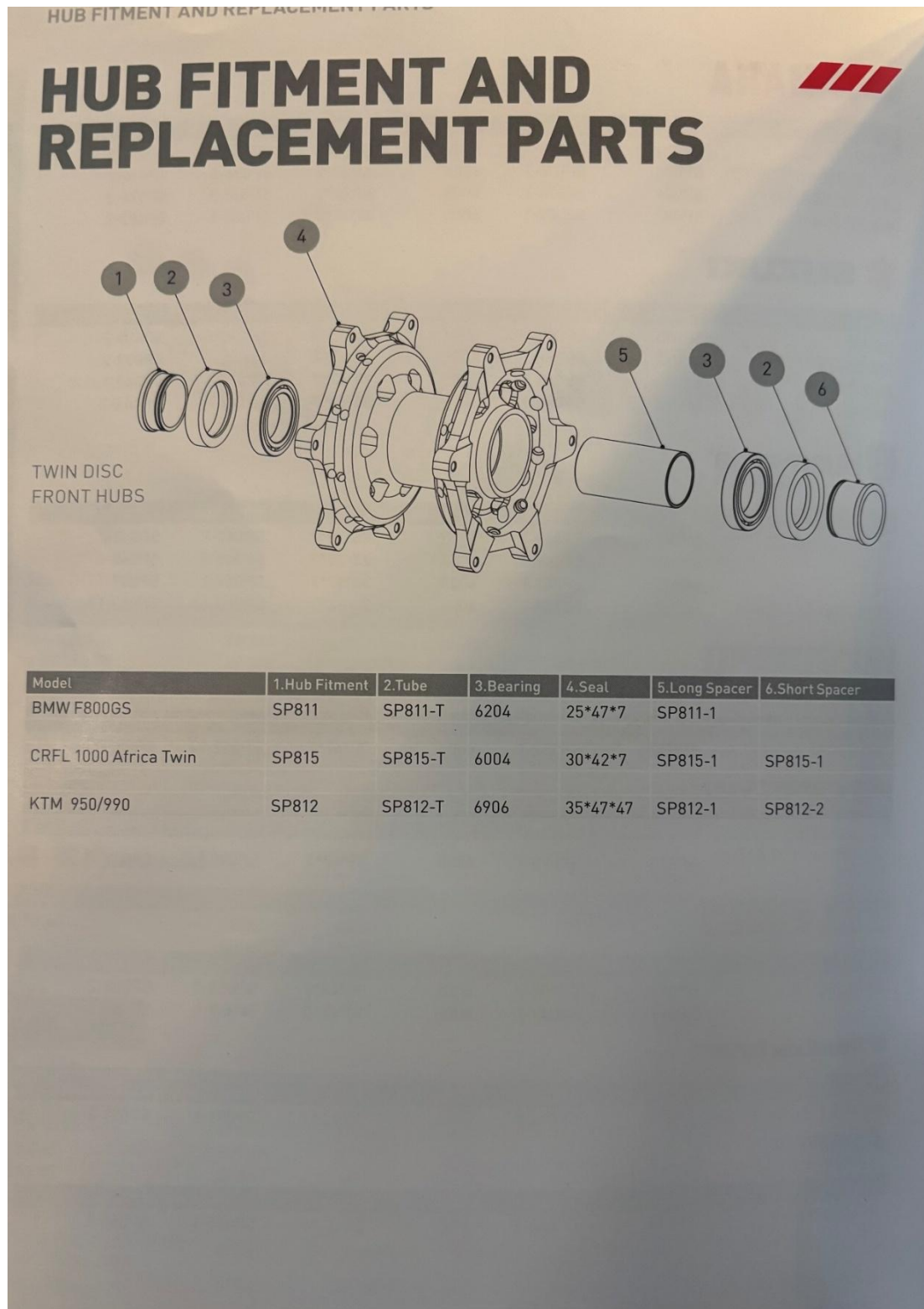

Torque Settings KTM EXC / Husqvarna TE-FE / GasGas EC

Component	Torque	Notes
Front axle nut	40–45 Nm	Ensure proper fork alignment
Rear axle nut	80–90 Nm	Check chain tension
Front axle pinch bolts	10 Nm (each)	Do not overtighten, tighten evenly
Brake disc bolts (front/rear)	10–12 Nm	Use Loctite 243, tighten in a crisscross pattern
Rear sprocket bolts	45–60 Nm	Use Loctite 243, tighten in a star pattern
Front sprocket bolt (central)	±45 Nm	Use Loctite 243 or locking plate (depending on model type)

These values apply to most models from **2017 to 2024**, but slight variations may exist depending on the year or model type.

Honda CRF – General Torque Settings

Component	Torque	Notes
Front axle nut	80–90 Nm	Ensure proper fork alignment
Rear axle nut	90–100 Nm	Check chain tension
Front axle pinch bolts	10–12 Nm	Do not overtighten, tighten evenly
Brake disc bolts (front/rear)	22–25 Nm	Use Loctite 243, tighten in a crisscross pattern
Rear sprocket bolts	45–50 Nm	Use Loctite 243, tighten evenly in a star pattern
Front sprocket bolt (central)	45–50 Nm	Use Loctite 243

These torque values are general guidelines for **Honda CRF models**. Always refer to the official service manual for your specific model and year when possible.

Yamaha WR – General Torque Settings

Component	Torque	Notes
Front axle nut	65–75 Nm	A light layer of grease on the axle is recommended
Rear axle nut	90–100 Nm	Check regularly during off-road use
Front axle pinch bolts	10–12 Nm	Tighten the upper bolts first, then the lower ones evenly
Brake disc bolts (front/rear)	20–22 Nm	Use Loctite 243, tighten in a crisscross pattern
Rear sprocket bolts	45–50 Nm	Use Loctite 243, tighten evenly in a star pattern
Front sprocket bolt (central)	45–50 Nm	Use a locking plate or Loctite

Tip: Always use a calibrated torque wrench and check that all bolts remain secure after the first ride — especially brake and sprocket bolts.

Spoke Tension Check

Warning – Risk of Accident

Unstable handling due to incorrect spoke tension.

– Always ensure proper spoke tension.

Information:

A loose spoke can cause the wheel to become unbalanced, which may result in additional spokes loosening over time.

If the spokes are overtightened, they may break due to localized stress.

Check spoke tension regularly, especially on new motorcycles.

How to Check Spoke Tension

– Lightly tap each spoke with the shaft of a screwdriver.

Note:

The sound frequency depends on the length and diameter of the spoke.

If spokes of equal length and thickness produce different tones, this indicates variations in tension.

A clear, consistent tone should be heard.

If Spoke Tension Varies

– Adjust the spoke tension accordingly.

Spoke Nipple Torque Settings

Component	Size	Torque
-----------	------	--------

Front wheel nipple	M4.5	6 Nm
--------------------	------	------

Rear wheel nipple	M4.5	6 Nm
-------------------	------	------